

DIMENSIONS

ISO/JIS
Type

Unit: mm

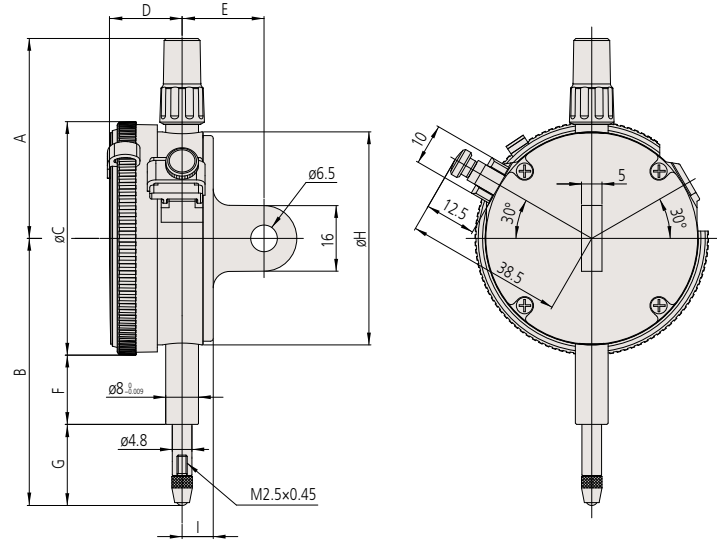

Note 1: Dimensions of the inch (ANSI/AGD Type) dial indicator partly differ from those of the metric (ISO/JIS Type) indicator.

Note 2: Inch (ANSI/AGD Type) dial indicators are provided with a stem of 3/8 inch dia. and #4-48UNF thread mount for the contact point.

| Order No. | A | B | C | D | E | F | G | H | I |
|-----------|------|------|----|------|----|------|------|----|-----|
| 2046S | 48.8 | 65.2 | 57 | 17.7 | 20 | 16.9 | 19.8 | 52 | 7.6 |
| 2046S-09 | 48.8 | 65.2 | 57 | 17.7 | 20 | 16.9 | 19.8 | 52 | 7.6 |
| 2047S | 48.8 | 65.2 | 57 | 17.7 | 20 | 16.9 | 19.8 | 52 | 7.6 |
| 2902S | 48.8 | 65.2 | 57 | 17.7 | 20 | 16.9 | 19.8 | 52 | 7.6 |
| 2310S-10 | 48.8 | 65.2 | 57 | 17.7 | 20 | 16.9 | 19.8 | 52 | 7.6 |
| 2044S | 48.8 | 65.2 | 57 | 17.7 | 20 | 16.9 | 19.8 | 52 | 7.6 |
| 2044S-09 | 48.8 | 65.2 | 57 | 17.7 | 20 | 16.9 | 19.8 | 52 | 7.6 |
| 2045S | 48.8 | 65.2 | 57 | 17.7 | 20 | 16.9 | 19.8 | 52 | 7.6 |

FEATURES

Metric

| Order No. | | | | | | | | | |
|-----------|-----------|------------|------------|-----------|-----------|-----------|-----------|-----------|-----------|
| w/ lug | Flat-back | 15° 0' 15" | 15° 0' 10" | 15° 0' 5" | 15° 0' 0" | 15° 0' 0" | 15° 0' 0" | 15° 0' 0" | 15° 0' 0" |
| 2046S | 2046SB | ✓ | — | — | — | — | — | — | — |
| 2046S-09 | 2046SB-09 | ✓ | — | — | ✓ | — | — | — | — |
| 2047S | 2047SB | — | ✓ | — | — | — | — | — | — |
| 2902S | 2902SB | — | — | ✓ | — | — | — | — | — |
| 2310S-10 | 2310SB-10 | ✓ | — | — | — | — | ✓ | — | ✓ |
| 2044S | 2044SB | ✓ | — | — | — | — | — | — | — |
| 2044S-09 | 2044SB-09 | ✓ | — | — | ✓ | — | — | — | — |
| 2045S | 2045SB | — | ✓ | — | — | — | — | — | — |

SPECIFICATIONS

Metric

□ ISO/JIS type

| Order No. | | Graduation | Range (range/rev) | Accuracy* | | | | Repeat-ability | Dial reading | Measuring force |
|-----------|-----------|------------|-------------------|-----------|---------|----------|-------|----------------|--------------|-----------------|
| w/ lug | Flat-back | | | Overall | Retrace | 1/10 Rev | 1 Rev | | | |
| 2046S | 2046SB | 0.01 mm | 10 mm (1 mm) | 13 μm | 3 μm | 5 μm | 10 μm | 3 μm | ±0-100 | 1.4 N or less |
| 2046S-09 | 2046SB-09 | 0.01 mm | 10 mm (1 mm) | 15 μm | 3 μm | 5 μm | 10 μm | 3 μm | ±0-100 | 1.4 N or less |
| 2047S | 2047SB | 0.01 mm | 10 mm (1 mm) | 13 μm | 3 μm | 5 μm | 10 μm | 3 μm | 0-50-0 | 1.4 N or less |
| 2902S | 2902SB | 0.01 mm | 10 mm (1 mm) | 13 μm | 3 μm | 5 μm | 10 μm | 3 μm | 100-0 | 1.4 N or less |
| 2310S-10 | 2310SB-10 | 0.01 mm | 10 mm (1 mm) | 15 μm | 3 μm | 5 μm | 10 μm | 3 μm | ±0-100 | 1.4 N or less |
| 2044S | 2044SB | 0.01 mm | 5 mm (1 mm) | 12 μm | 3 μm | 5 μm | 10 μm | 3 μm | ±0-100 | 1.4 N or less |
| 2044S-09 | 2044SB-09 | 0.01 mm | 5 mm (1 mm) | 12 μm | 3 μm | 5 μm | 10 μm | 3 μm | ±0-100 | 1.4 N or less |
| 2045S | 2045SB | 0.01 mm | 5 mm (1 mm) | 12 μm | 3 μm | 5 μm | 10 μm | 3 μm | 0-50-0 | 1.4 N or less |

* Completed products inspection is performed in the vertical position (contact point downward) and the stated accuracy is guaranteed.